

THIS AGREEMENT is made the THIRD day of NOVEMBER
One thousand nine hundred and ninety

BETWEEN THE BROADS AUTHORITY ("the Authority") of Thomas Harvey
House 18 Colegate Norwich of the first part and ROBERT GUY EAVES and
MARGARET ANN EAVES ("the Owners") both of The Chimes Belfrey Orchard
Uckfield Sussex TN22 5DP of the second part

WHEREAS :-

(1) The Authority is the District Planning Authority for the purposes
of the Town and Country Planning Act 1990 ("the Act") for the area
within which the land shown edged red on the annexed plan ("the Land")
is situated

(2) The Owners are the owners in fee simple in possession of the Land

(3) The Owners have made application (reference 90/0887) in accordance
with the Act and the orders and regulations for the time being in
force thereunder for planning permission to develop the Land by the
replacement of an existing chalet ("the Chalet")

NOW THIS DEED WITNESSETH as follows:-

1. This Agreement is made in pursuance of Section 106 of the Act
Section 33 of the Local Government (Miscellaneous Provisions) Act 1982
and all other enabling powers

2. The Owners hereby covenant jointly and severally with the Authority
that in the event of planning permission being granted for the
Chalet:-

(i) they will make and keep up to date a register of bookings
for the Chalet and make that register available for inspection
by the Authority or any officer nominated by it

(ii) they will not cause or permit the Chalet to be occupied
between 5th January and 17th March and 1st November and 20th
December inclusive in any year

3. The expressions "the Authority" and "the Owners" shall include their respective successors and assigns as appropriate within the terms of Section 106 of the Act

I N W I T N E S S whereof the Authority has affixed its Common Seal and the Owners have signed this Instrument as their deed the day and year first before written

THE COMMON SEAL of THE BROADS)
AUTHORITY was hereunto affixed)
in the presence of:-)

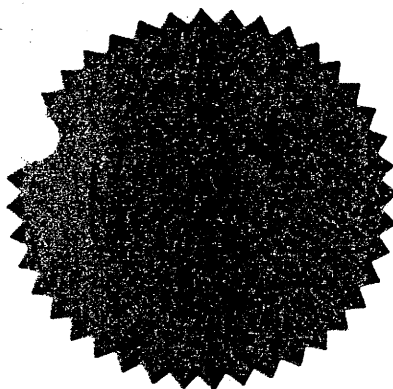

Authorised to sign on behalf
of the Solicitor to the Broads Authority

SIGNED as his deed)
by the said ROBERT GUY)
EAVES in the presence of:-)

G. B. Russell
20 St Marys Gorth
Buxted
E. Sussex

SIGNED as her deed)
by the said MARGARET ANN)
EAVES in the presence of:-)

G. B. Russell
20 St Marys Gorth
Buxted
E. Sussex.

5/90/0887

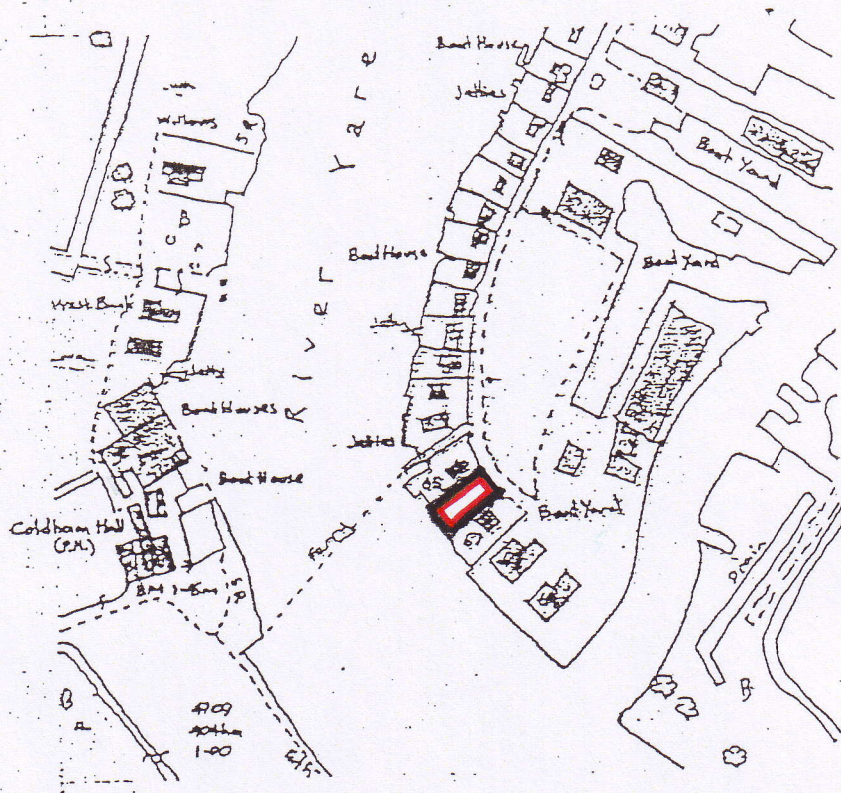

Location plan 1:2500

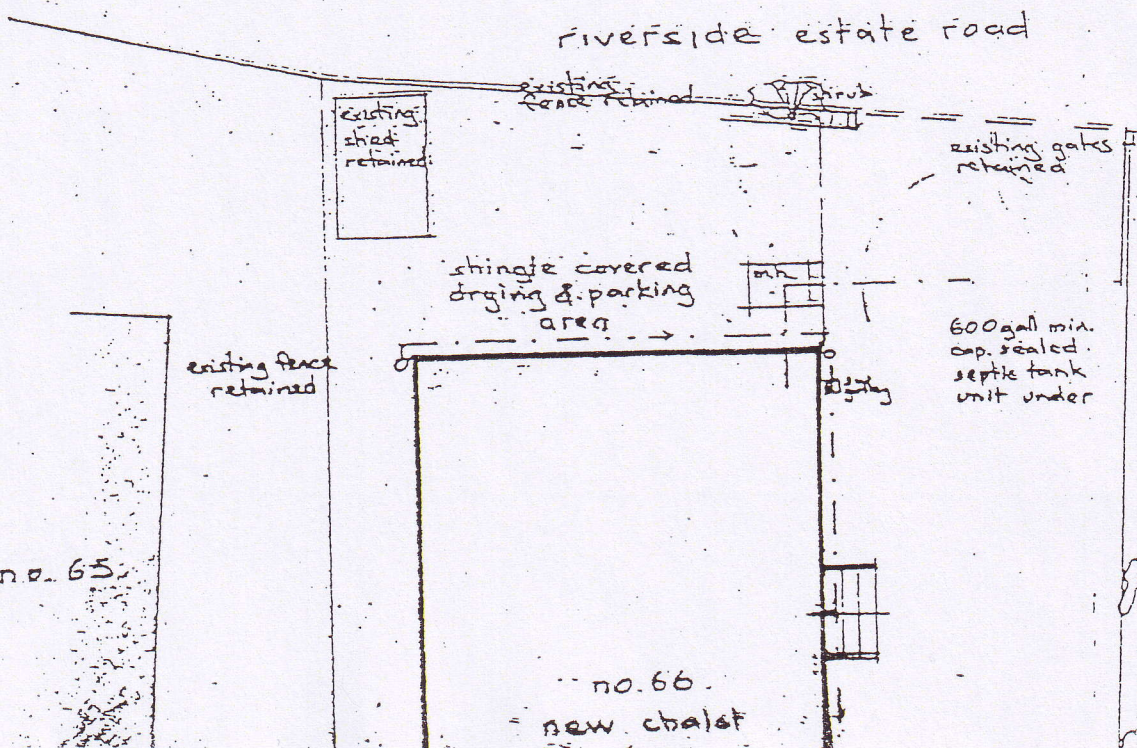

DATED 3rd November 1990

THE BROADS AUTHORITY

- and -

ROBERT GUY EAVES

- and -

MARGARET ANN EAVES

A G R E E M E N T

under Section 106 of the Town and Country
Planning Act 1971 relating to land at
Brundall.

T.D.W. Molander, Esq.,
Solicitor to the Broads Authority,
County Hall,
Martineau Lane,
Norwich,
NR1 2DH.