

T H I S   A G R E E M E N T   is made the day 11<sup>th</sup> of September  
One thousand nine hundred and ninety one

B E T W E E N   THE BROADS AUTHORITY ("the Authority") of Thomas Harvey  
House 18 Colegate Norwich of the first part and ALAN WHITTAKER and JOAN  
VALERIE WHITTAKER ("the Owners") both of 45 Whitlowdale Road Sheffield S7  
2NE of the second part

W H E R E A S:-

(1) The Authority is the District Planning Authority for the purposes  
of the Town and Country Planning Act 1990 ("the Act") for the area within  
which the land shown edged red on the annexed plan ("the Land") is  
situated

(2) The Owners are the owners in fee simple in possession of the Land

(3) Application has been made (reference 90/1739) dated 13th September  
1990 in accordance with the Act and the orders and regulations for the  
time being in force thereunder for planning permission to develop the  
Land by the construction of quay heading ("the Development")

N O W   T H I S   D E E D   W I T N E S S E T H   as follows:-

1. This Agreement is made in pursuance of Section 106 of the Act Section  
33 of the Local Government (Miscellaneous Provisions) Act 1982 and all  
other enabling powers

2. The Owners hereby covenant jointly and severally with the Authority  
that in the event of planning permission being granted for the  
Development they will not cause or permit any mooring of boats to take  
place on the river frontage shown in yellow on the attached plan

3. This document is executed as a Deed and is delivered on the date first  
before written

4. The expressions "the Authority" and "the Owners" shall include their  
respective successors and assigns as appropriate within the terms of  
Section 106 of the Act

I N W I T N E S S whereof the Authority has affixed its Common Seal and  
the Owners have signed this Instrument as their Deed the day and year  
first before written

THE COMMON SEAL of THE)  
BROADS AUTHORITY was )  
hereunto affixed in )  
the presence of:- )

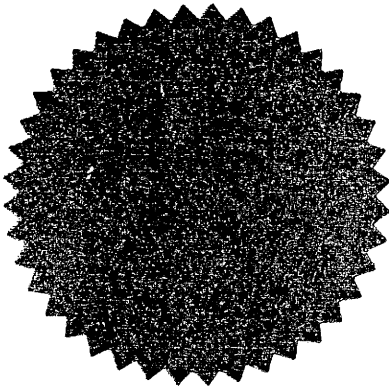

*Chapman*

Solicitor to the Authority

SIGNED as his DEED by the)  
said ALAN WHITTAKER in )  
the presence of:- )

*A Whittaker*

*Witness*

*J. V. Whittaker*  
29 Plymouth A  
Sheffield 7.

SIGNED as her DEED by the )  
said JOAN VALERIE WHITTAKER )  
in the presence of:- )

*J. V. Whittaker*

*J. V. Whittaker*  
29 Plymouth A  
Sheffield 7.

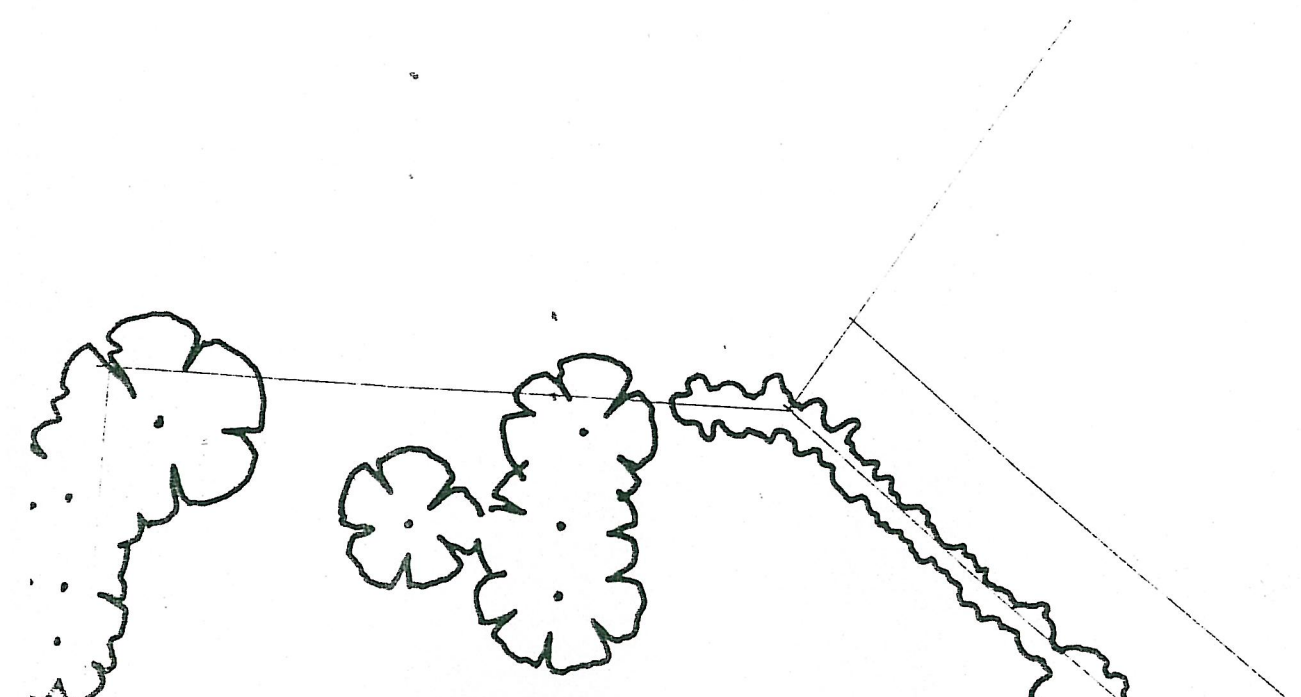
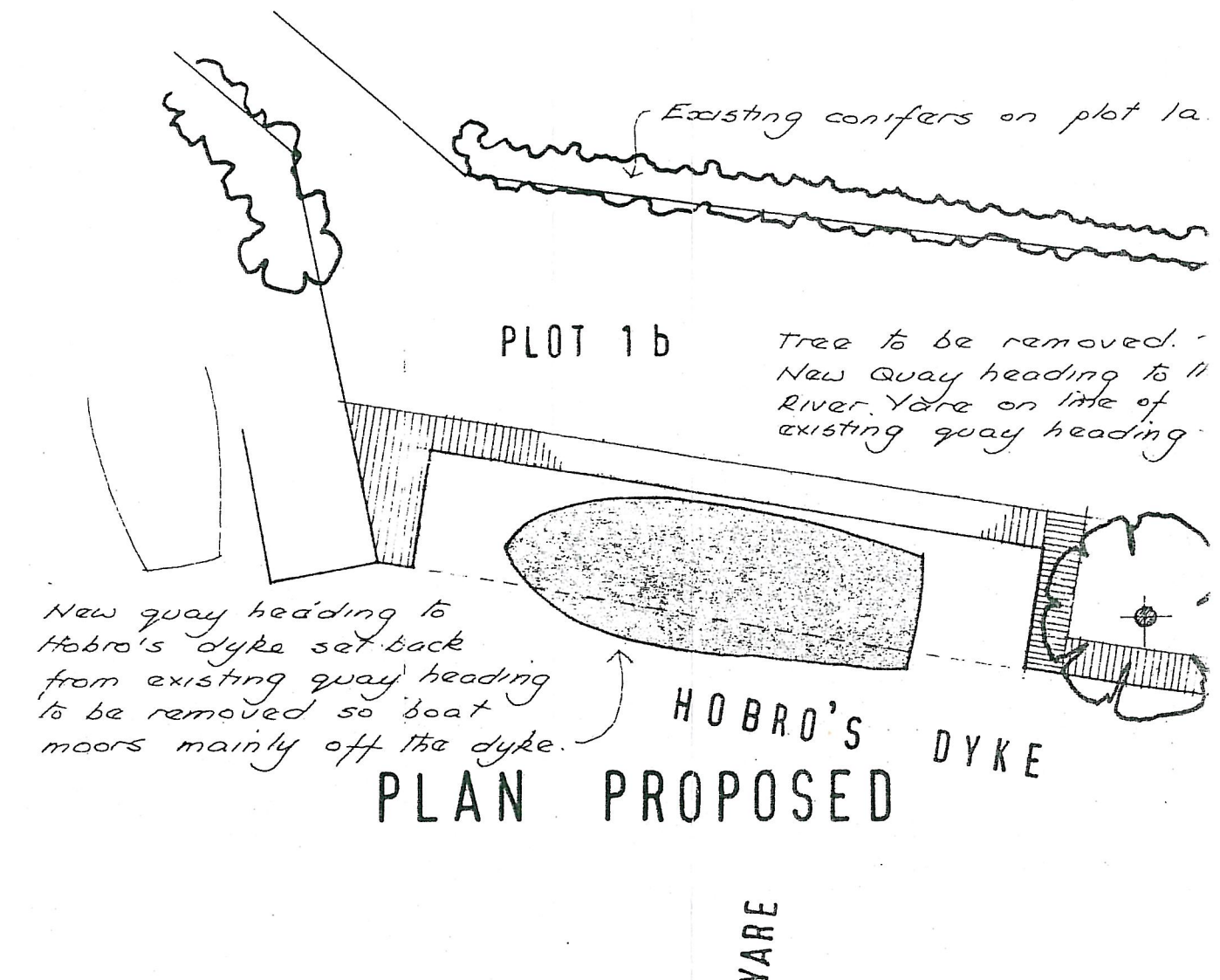
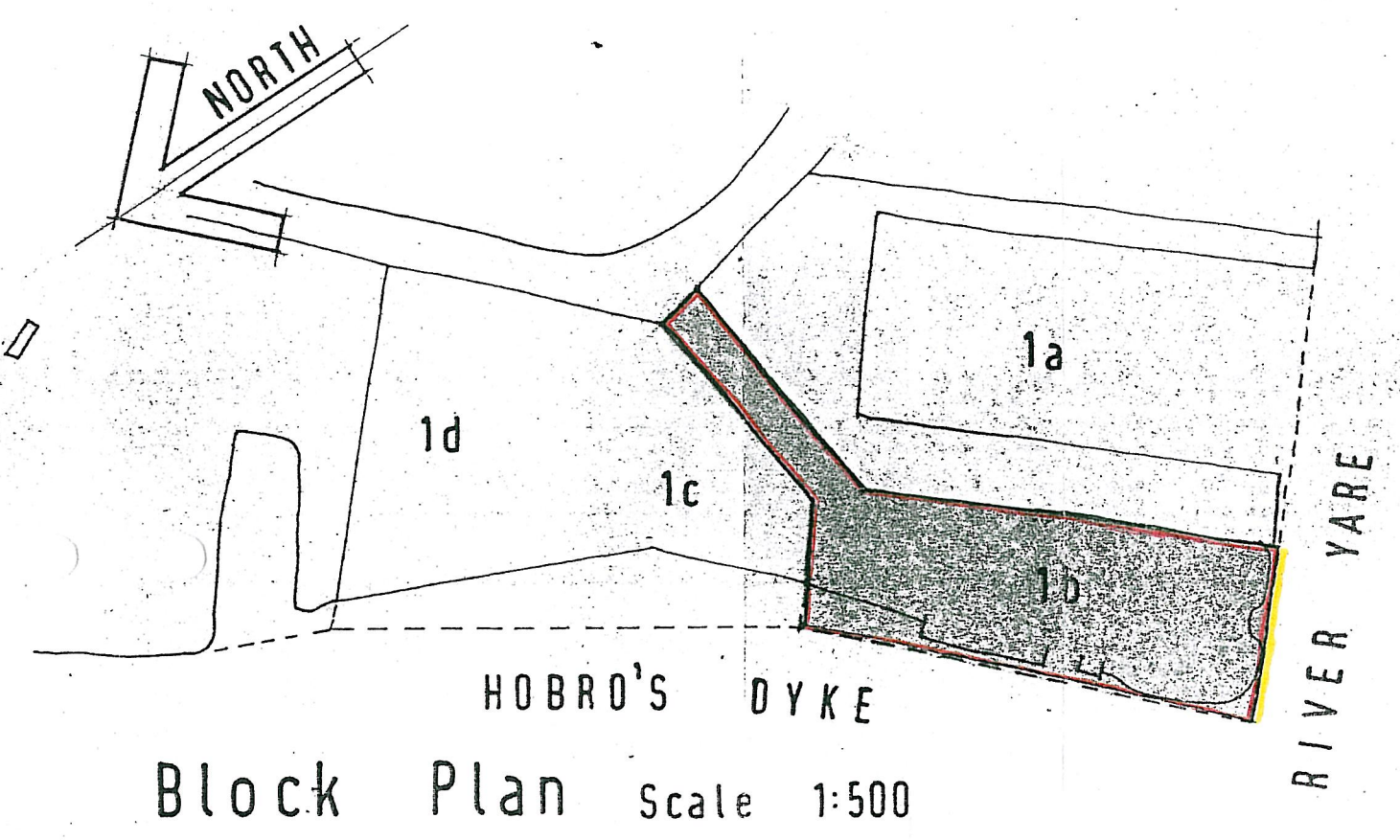
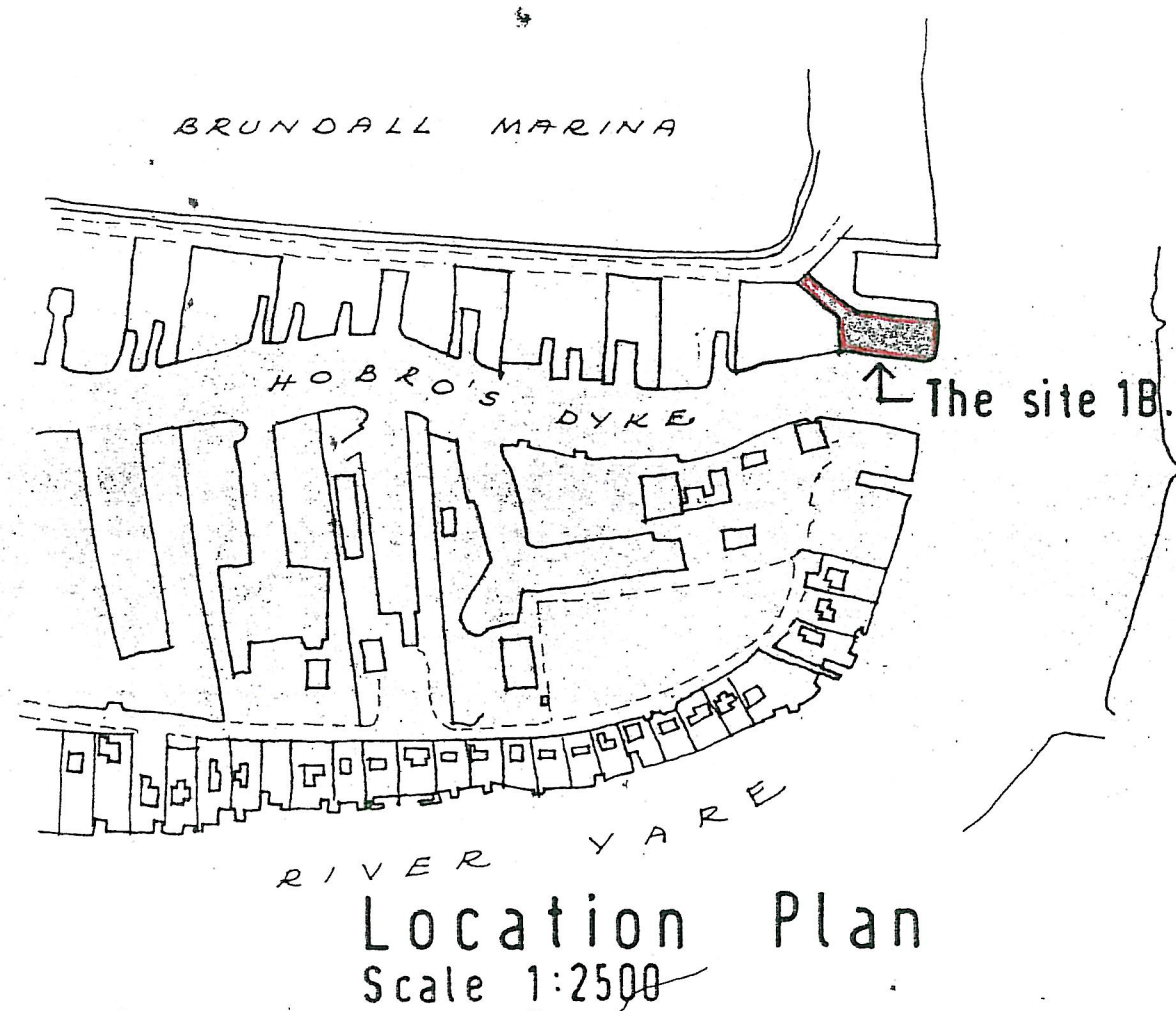

DATED 11<sup>th</sup> September 1991

THE BROADS AUTHORITY

- and -

ALAN WHITTAKER

- and -

JOAN VALERIE WHITTAKER

A G R E E M E N T

under Section 106 of the Town and  
Country Planning Act 1990 relating to  
land at Brundall.

T.D.W. Molander, Esq.,  
County Hall,  
Martineau Lane,  
Norwich.  
NR1 2DH

Vol5Whittaker(Agreement)1-3/SMC