



THIS AGREEMENT is made the 23rd

day of September 1976 BETWEEN THE BROADLAND DISTRICT COUNCIL (hereinafter called "the Council") of the one part and DEREK GEORGE CRANE Builder of 'Lion House', The Moor, Reepham, in the County of Norfolk (hereinafter called "the Owner") of the other part

WHEREAS

(1) The Council is the Local Planning Authority for the purposes of this agreement.

(2) The Owner is seised in unincumbered fee simple in possession of property described in the First Schedule hereto (hereinafter called "the Property")

(3) Pursuant to Section 52 of the Town and Country Planning Act 1971 the Council and the Owner have agreed to complete this agreement
NOW THIS DEED WITNESSETH as follows:

1. Pursuant to Section 52 of the said Act the Owner hereby agrees declares and covenants with the Council that the Property shall permanently be subject to the conditions (restricting or regulating the development or use of the land) specified in the Second Schedule hereto.
2. It is agreed that Section 126 of the Housing Act 1974 shall apply to this Agreement and the covenants herein appearing.
3. The expressions "the Council" and "the Owner" shall where the context admits include their respective successors in title and assigns.

IN WITNESS whereof the Council have hereunto caused their Common Seal to be affixed and the Owner has affixed his Hand and Seal the day and year first above written.

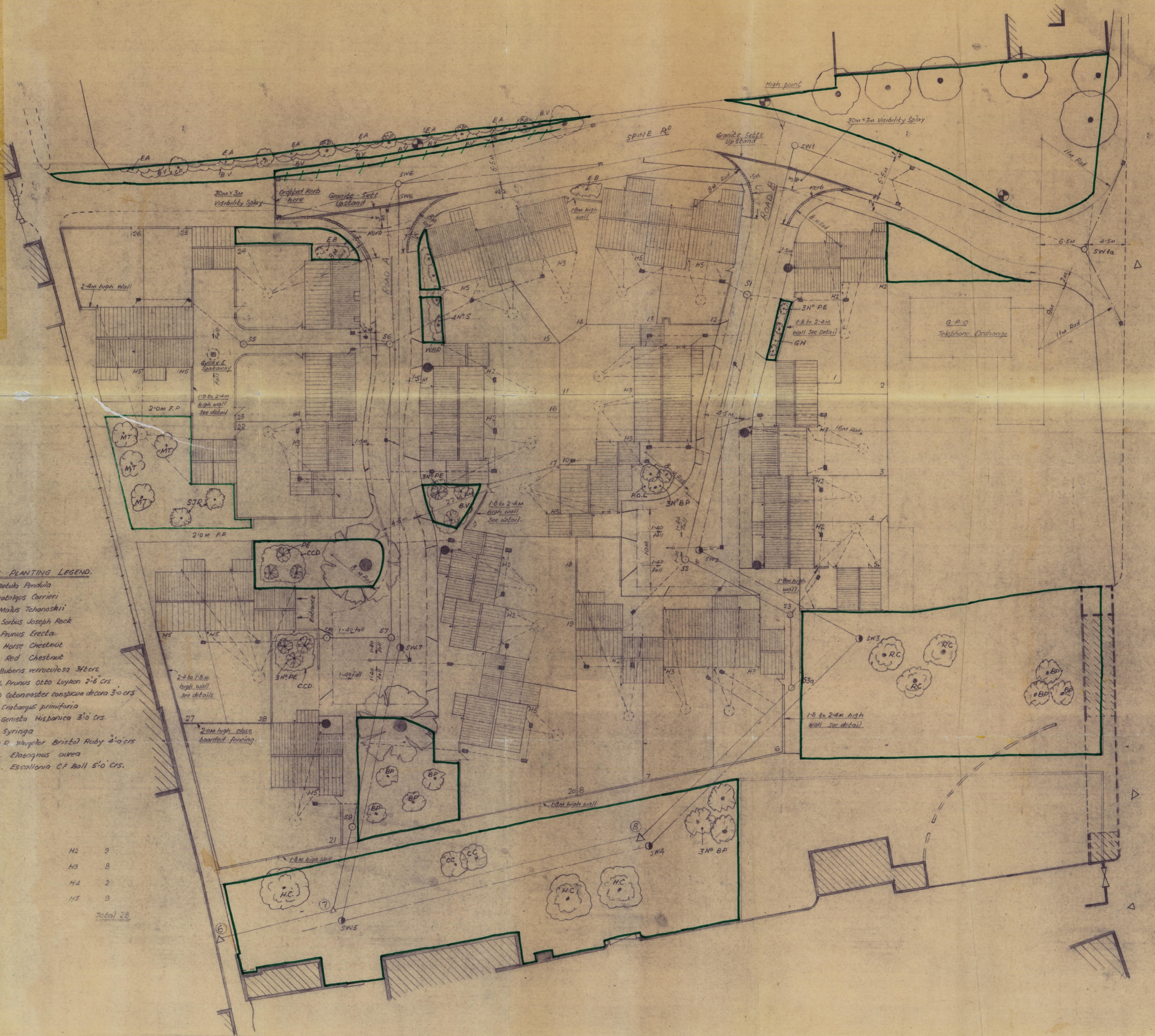

MATERIAL SCHEDULE

All roofs To be Crossley Tudor Red Clay Pantiles.

All screen Walls Valley (Bristol) Mulen-Red Facings

The following dwellings & Garages to be in Valley (Bristol) Red Facings

Plots 1 & 2. Plots 4, 5 + 2^{Nº} garages.

Plot 8 + 2^{Nº} garages for plots 6 & 7.

Plots 10 & 11 + 1^{Nº} Garage to Plot 11.

Plots 14, 15 + 1^{Nº} Garage + 1^{Nº} Garage & Utility Room

Plots 18, 19, 20 + 2^{Nº} Garage + 1^{Nº} Garage & Utility Room.

Plots 21 & 22 + 1^{Nº} " + " " " "

Plots 24, 25, 26, + 4^{Nº} Garages.

TREE PLANTING LEGEND.

B.R. Betula Pendula
C.C. Crataegus Carrieri
M.T. Malus Tahanaskii
S.J.R. Sorbus Joseph Rock
P.E. Prunus Erecta
H.C. Horse Chestnut
R.C. Red Chestnut
BV Buberis verruculosa 3fters
P.O.L. Prunus Otto Luyken 2-6' crs
C.C.D. Cotoneaster conspicua decora 3-0 crs.
C.P. Crataegus pruinifolia
GH. Genista Hispanica 3'-0 crs.
S. Syringa
W.B.R. Weigela Bristol Ruby 4'-0 crs.
E.A. Elaeagnus aurea
E.B. Escallonia CF Ball 5'-0 crs.

LEGEND

150m dia ——— Foul Sewer.

225% dia ——— Surface Water Sewer.

100m dia - - - - - Sewelling Drains.

150m Road Gully.

Inspection Chambers

Foul Sewer Manholes

Surface Water Manholes

Safelcub DBA2.

Existing Foul Sewer M.H.s

Sideways

ROADS A & B Drainage by
Charcon Products Ltd
Hulland Ward, Derby DE63ET
DBA2 Safelcub & 150m Traps.

See Drg A16/1/4/01

THE COMMON SEAL OF THE)
BROADLAND DISTRICT COUNCIL)
was hereunto affixed in the)
presence of:)



J. Wade

Chairman

P. M. Taylor

Chief Executive and Clerk

SIGNED SEALED AND DELIVERED)
by DEREK GEORGE CRANE)
in the presence of:)

D. G. Crane

Witness Name

John Smith

Address

*Shirton
Norwich*

Occupation

THE FIRST SCHEDULE REFERRED TO:

THE PROPERTY

The several plots of land at School Road in the Parish of Reepham which for the purposes of identification are shown edged in green on the drawing annexed hereto (hereinafter called "the Drawing") forming part of Ordnance Survey enclosure number 198 and being the proposed open spaces and amenity areas in connection with the housing estate which is the subject of an application for planning consent numbered 76.0919.

THE SECOND SCHEDULE REFERRED TO:

THE CONDITIONS

1. Prior to the occupation of any dwelling erected on the said housing estate or within such longer period as shall be agreed in writing by the Council the Owner will lay out the Property as open spaces seed with grass and plant with trees and shrubs as indicated on the drawing in a manner appropriate to the species and in the position shown on the drawing or where appropriate build brick retaining walls fill with soil and plant as ornamental areas.
2. The Owner will thereafter maintain the grass trees shrubs and ornamental areas on the Property in a proper and tidy condition and will replace any tree or shrub which fails or dies by a tree or shrub of the same type or quality or such other type as may be approved by the Council.

Dated

23rd September

1976

BROADLAND DISTRICT COUNCIL

- and -

DEREK GEORGE CRANE

A G R E E M E N T

Under Section 52 of the
Town and Country Planning
Act 1971