

TOWN AND COUNTRY PLANNING GENERAL DEVELOPMENT ORDER 1988
DIRECTION RESTRICTING PERMITTED DEVELOPMENT

WHEREAS THE SOUTH NORFOLK DISTRICT COUNCIL being the appropriate local planning authority within the meaning of articles 4 and 5 of the Town and Country Planning General Development Order 1988 (hereinafter called "the Order") are of the opinion that development of the description set out in the Schedule hereto should not be carried out on land at Windy Lane, Saxlingham Nethergate being the land shown edged red on the plan annexed hereto unless permission therefor is granted on application made under the Order.

AND WHEREAS the Council are further of the opinion that development of the said description would constitute a threat to the amenities of their area and that the provisions of paragraph 4 of article 5 of the Order thus applies to this direction.

NOW THEREFORE the said Council in pursuance of the power conferred upon them by the said articles 4 and 5 hereby direct that the permission granted by article 3 of the Order shall not apply to development on the said land of the description set out in the Schedule hereto

THIS DIRECTION is made in pursuance of the provisions of paragraph 4 of article 5 of the Order and shall remain in force until 8th June 1989 (being six months from the date of this direction) and will then expire unless it has been approved by the Secretary of State for the Environment before that date.

SCHEDULE Part 2 Minor Operations

Class A - the erection, construction, maintenance, improvement or alteration of a gate, fence, wall or other means of enclosure.

being development comprised within Class A of Part 2 referred to in Schedule 2 to the Order and not being development comprised within any other class.

Given under the Common Seal of the South
Norfolk District Council this 9th
day of December, 1988



6041

The Common Seal of the Council was hereunto
affixed in the presence of:

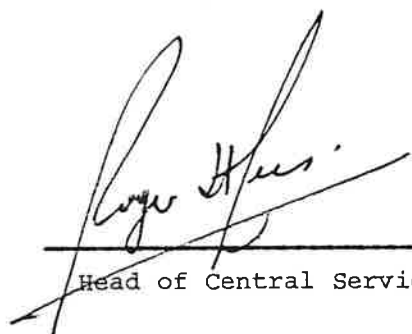
Head of Central Services

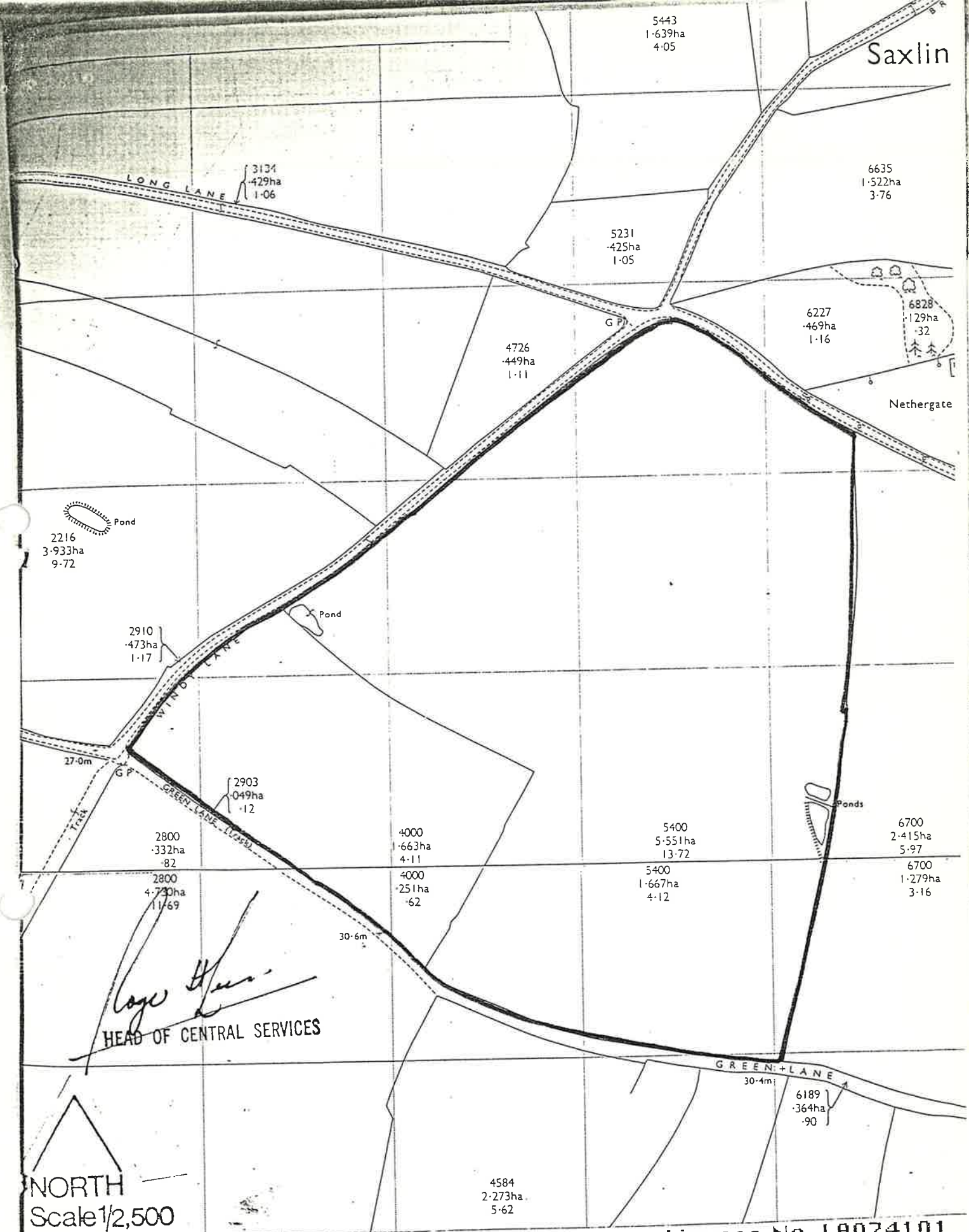

South Norfolk District Council

Licence No. LA074101

Reproduced from the Ordnance Survey Map with the sanction of the controller of H.M.S.O., Crown Copyright Reserved.