



# Departments of the Environment and Transport

Eastern Regional Office

Charles House 375 Kensington High Street London W14 8QH

Telephone 01-603 3444 ext 454

The Clerk of the Council  
South Norfolk District Council  
South Norfolk House  
Swan Lane  
LONG STRATTON  
Norwich NR15 2XE

Your reference

PH5/C/13

Our reference

E1/5321/19/13

Date

14 April 1982

Sir

TOWN AND COUNTRY PLANNING ACT 1971  
TOWN AND COUNTRY PLANNING GENERAL DEVELOPMENT ORDER 1977  
DIRECTION UNDER ARTICLE 4

1. I am directed by the Secretary of State to refer to your Council's direction under Article 4 (1) in respect of land at Costessey.

2. The Secretary of State has given full consideration to the Council's reasons for making the direction and to the direction itself. He has also considered carefully the views expressed by your Council in their letter of 26 March. He is satisfied that there is adequate justification for him to approve the direction in respect of the western half of the direction site. As far as the eastern half is concerned he is not so satisfied. There is no evidence that the threat of tipping extends at present to the eastern half, which he understands to be in different ownership; much of that land has been reclaimed from sedge and put down to grass or ploughed. The Secretary of State does not therefore propose to approve the direction in respect of this land.

3. The direction has accordingly been modified in red to cover only the land shown hatched green on the direction plan. I am therefore returning one copy of the modified direction endorsed with the Secretary of State's approval. The Council's attention is drawn to the provisions of Articles 4(5) and 4(6) of the General Development Order which relates to the publication or service of notice of the direction.

I am Sir

Your obedient Servant

*J W M Rogers*

J W M ROGERS

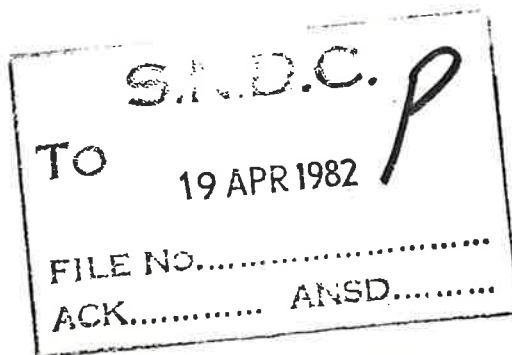

SOUTH NORFOLK DISTRICT COUNCIL  
TOWN AND COUNTRY PLANNING GENERAL DEVELOPMENT ORDER, 1977  
DIRECTION RESTRICTING PERMITTED DEVELOPMENT  
(COSTESSEY NO. 1) 1981

WHEREAS the South Norfolk District Council (hereinafter referred to as "the Council") being the appropriate local planning authority as defined by Article 4 of the Town and Country Planning General Development Order 1977 (hereinafter called "the Order") are of the opinion that development of the description set out in Schedule 1 hereto should not be carried out on the land specified in Schedule 2 hereto unless permission therefor is granted on an application made in that behalf under the Order.

NOW THEREFORE the Council in pursuance of the powers conferred on them by the said Article 4 HEREBY DIRECT THAT the permission granted by Article 3 of the Order shall not apply to development of the description set out in Schedule 1 hereto on the land specified in Schedule 2 hereto.

SCHEDULE 1 REFERRED TO

The carrying out on agricultural land having an area of more than one acre and comprised in an agricultural unit of engineering operations, namely the raising of the level of the land by tipping spoil, hardcore, builder's rubble and other materials thereon, requisite for the use of that land for the purposes of agriculture, being development comprised within Class VI paragraph 1 referred to in Schedule 1 to the Order and not being development comprised within any other Class.

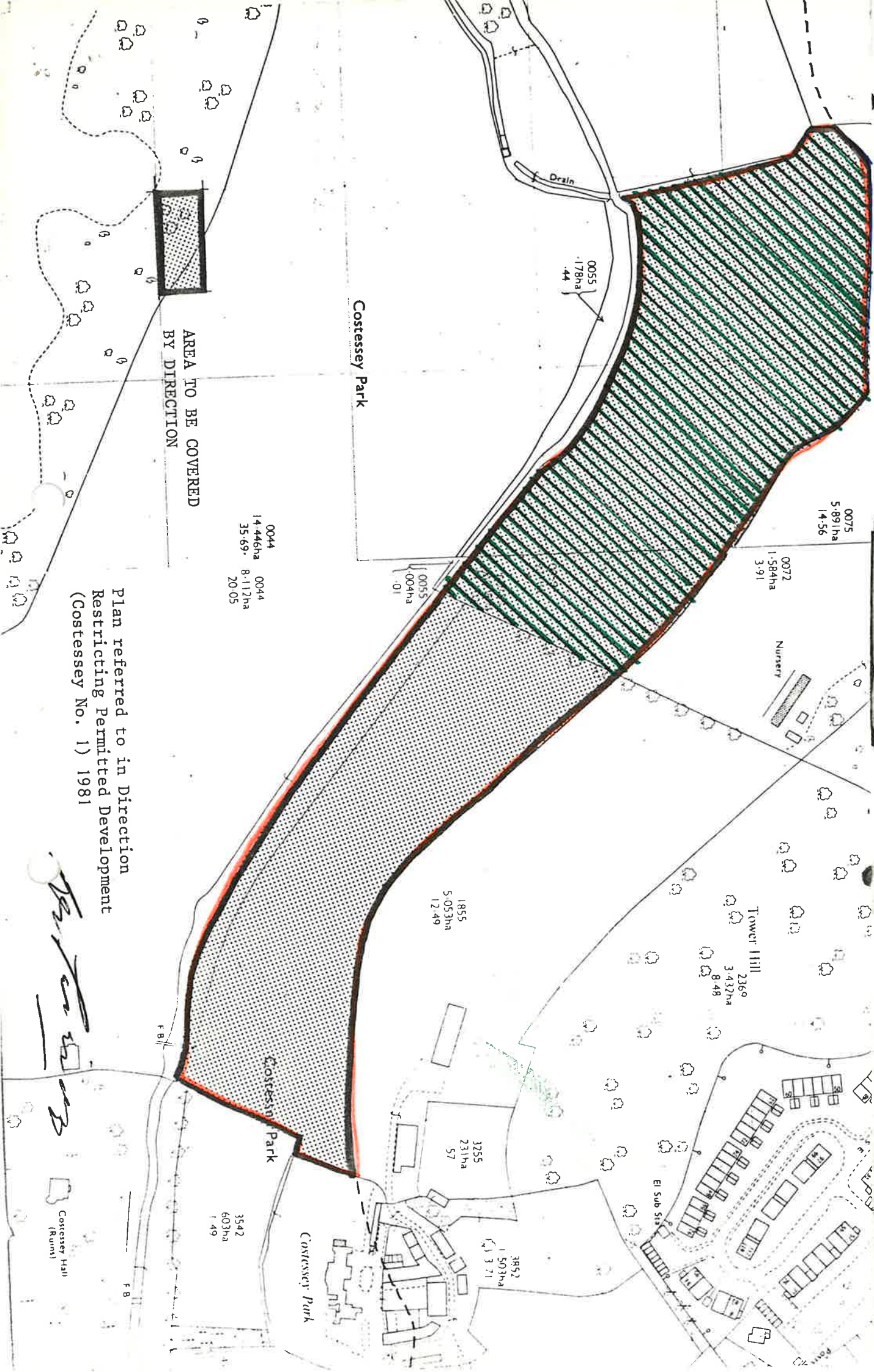

AREA TO BE COVERED  
BY DIRECTION

Plan referred to in Direction  
Restricting Permitted Development  
(Costessey No. 1) 1981

*[Handwritten signature]*

Costessey Hall  
(Ruins)



SCHEDULE 2 REFERRED TO

O.S. Parcel numbers

Part O.S. 0075 : (1970 edition)

O.S. 0059 : (1975 edition)

Part O.S. 0072 : (1975 edition)

~~Part O.S. 1055 : (1975 edition)~~

in the parish of Costessey in the District of South Norfolk  
the County of Norfolk shown edged ~~red~~ <sup>and hatched green</sup> on the plan annexed hereto

MADE under the Common Seal of the Council this

*twelfth* day of *October*

1981

THE COMMON SEAL OF THE COUNCIL WAS  
HEREUNTO AFFIXED IN THE PRESENCE OF:

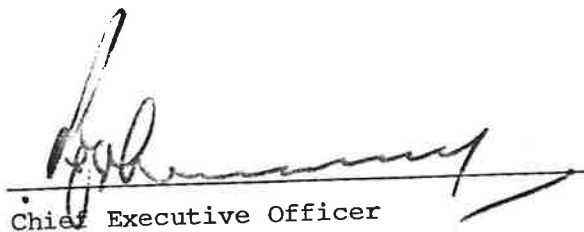
  
Chief Executive Officer

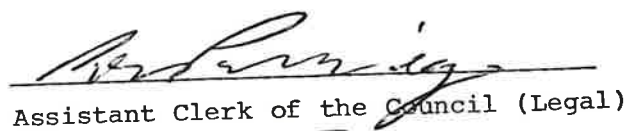
  
Assistant Clerk of the Council (Legal)

The Secretary of State for the Environment  
hereby approves the foregoing direction  
subject to the modifications shown in red ink  
thereon.

  
Signed by authority  
of the Secretary of  
State

\*A Regional Controller  
in the Department of  
the Environment.

C2/22

14 APRIL 1982