

AN AGREEMENT made the 3rd day of June One
Thousand Nine Hundred and Eight-Two BETWEEN BROADLAND DISTRICT
Council of Thorpe Lodge Yarmouth Road Norwich in the County of
Norfolk (hereinafter called "the Council") of the one part and
Mr. D.W. Jones of Brick Kiln Farm Kerdiston Reepham Norwich in
the County of Norfolk and Mr. B.W. Daws of Reepham New House
Norwich Road Reepham Norwich in the County of Norfolk
(hereinafter called "the applicants") of the other part

WHEREAS:

1. The applicants are the owners of the property shown on
the plan hereto and known as Wood Dalling Hall Wood Dalling
Norfolk
2. The Council is the local planning authority for the
purposes of the Town and Country Planning Act 1971
3. This Agreement is made pursuant to the provisions of
Section 52 of the Town and Country Planning Act 1971 for the
purposes of regulating proposed development at the property
by the applicants and it is further agreed between the parties
that the provisions of Section 126 of the Housing Act 1974
shall apply

NOW THIS DEED WITNESSETH AS FOLLOWS

The applicants hereby covenant with the Council that in the
event of the applicants being granted planning permission for
development of the property they will use the property for the
purposes of holiday accommodation only and will not use or
permit to be used the property or any part thereof or any
building now erected or to be erected thereon except the

building shown coloured red on the plan attached hereto as permanent residential accommodation.

It witness where of the Council has caused its seal to be affixed and the applicants have hereunto set their hand and seal the day and year first before written

THE COMMON SEAL OF
BROADLAND DISTRICT COUNCIL
was hereunto affixed in
the presence of:



[Signature]
Chairman

[Signature]
Chief Executive & Clerk

SIGNED SEALED AND DELIVERED
by the said
D W JONES
in the presence of:

[Signature]

[Signature]

2 Beech Drive,
Strumpsham
Norwich

BUILDING OUTLINED IN RED
IS NOT SUBJECT TO COVENANTS
CONTAINED IN SECTION 52 AGREEMENT

Wood Dalling
Hall

Hall

Outbuildings

SITE PLAN

Scale - 1:1000

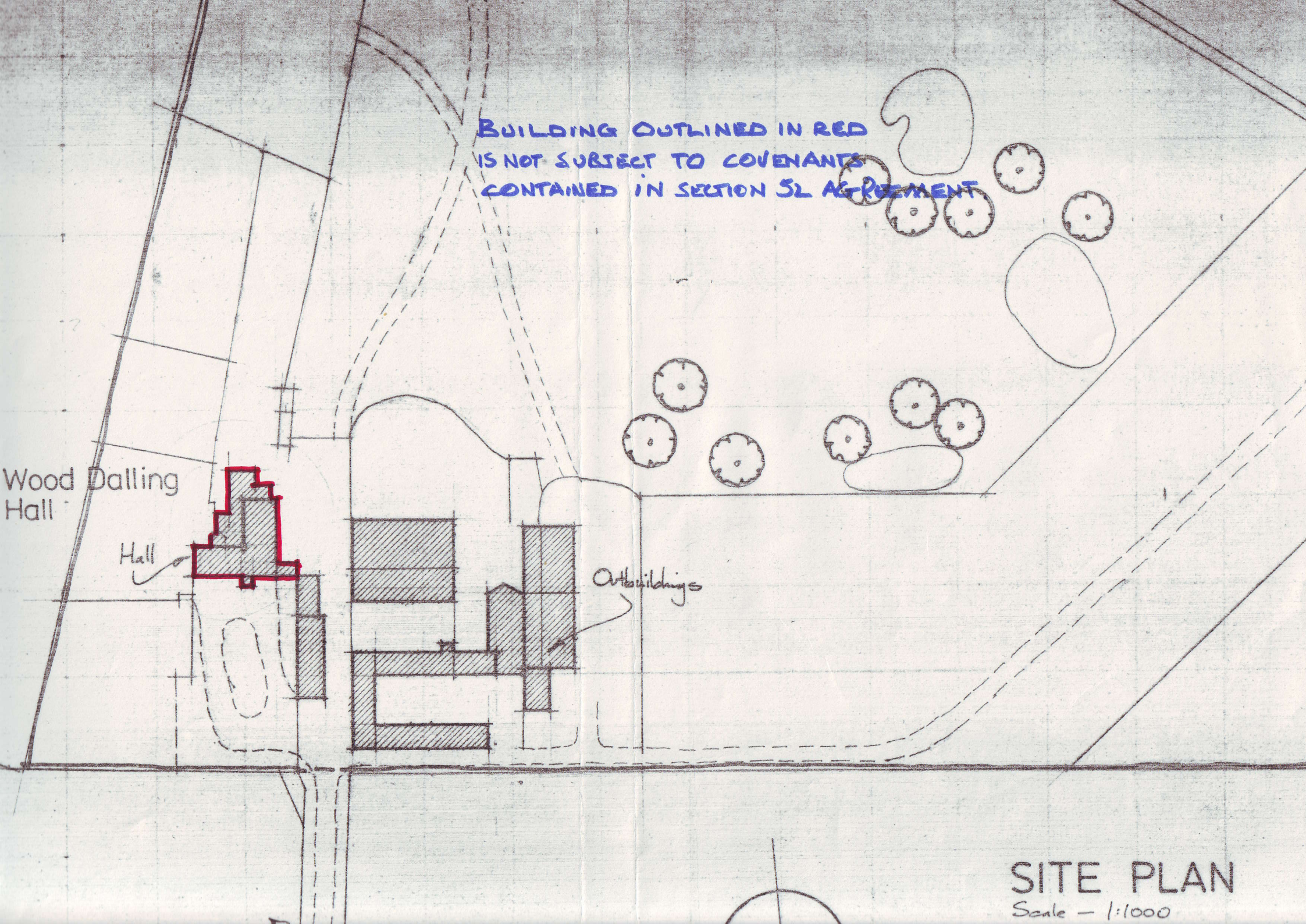

SIGNED SEALED AND DELIVERED)

by the said

B W DAWS

in the presence of:

B. W. Daws

Mr. Wilson

2 Beech Drive

Sturminster

Norwich.