

THIS AGREEMENT is made the 8th day of September 1982 BETWEEN BROADLAND
DISTRICT COUNCIL of Thorpe Lodge Yarmouth Road Norwich in the County of
Norfolk (hereinafter called "the Council") of the one part and ROY
DUNTHORNE, JOAN KATHLEEN DUNTHORNE, PAUL STEPHEN DUNTHORNE AND SANDRA
DUNTHORNE of Hill House Farm Limpenhoe in the County of Norfolk
(hereinafter called "the Owners") of the other part _____

WHEREAS

1. The Council is the Local Planning Authority for the purpose of this Agreement _____
2. The Owners are seised in fee simple absolute in possession of the property described in the First Schedule hereto (hereinafter called "the property") free from incumbrances _____
3. The Owners have applied to the Council under reference number 82.0918 for Planning Permission for development to be carried out on the property hereinafter described
4. The Council and the Owners have agreed subject to Planning Permission being granted in consequence of the aforesaid application to enter into this agreement pursuant to Section 52 of the Town and Country Planning Act 1971 and Section 126 of the Housing Act 1974 _____

NOW THIS DEED WITNESSETH as follows:

1. Subject to Planning Permission being granted in consequence of Application Number 82.0918 and pursuant to Section 52 of the said Act the Owners hereby agree declare and covenant with the Council that from the date on which the aforesaid Planning Permission shall be granted the property shall be permanently subject to the conditions restricting or regulating the development or use of the property specified in the Second Schedule hereto _____
2. The expressions "the Council" and "the Owners" shall where the context so admits include their respective successors in title and assigns _____

IN WITNESS whereof the Council has hereunto caused its Common Seal to be affixed and the Owners have hereunto set their hands and seals the day and year first before written _____

THE FIRST SCHEDULE REFERRED TO

THE PROPERTY

ALL THAT land situated at Church Farm Wickhampton in the Parish of Freethorpe in the County of Norfolk forming Enclosure No. 8158 on the Ordnance Survey Map for the said Parish as the same is for the purpose of identification only shown edged red on the plan annexed hereto _____

THE SECOND SCHEDULE REFERRED TO

THE CONDITIONS

The building upon the property for which planning permission is sought under reference No. 82.0918 shall not be used at any time for the keeping of pigs intensively on the slatted floor system of slurry disposal unless the written consent and approval of the Council shall first have been obtained to the proposed method of slurry disposal _____

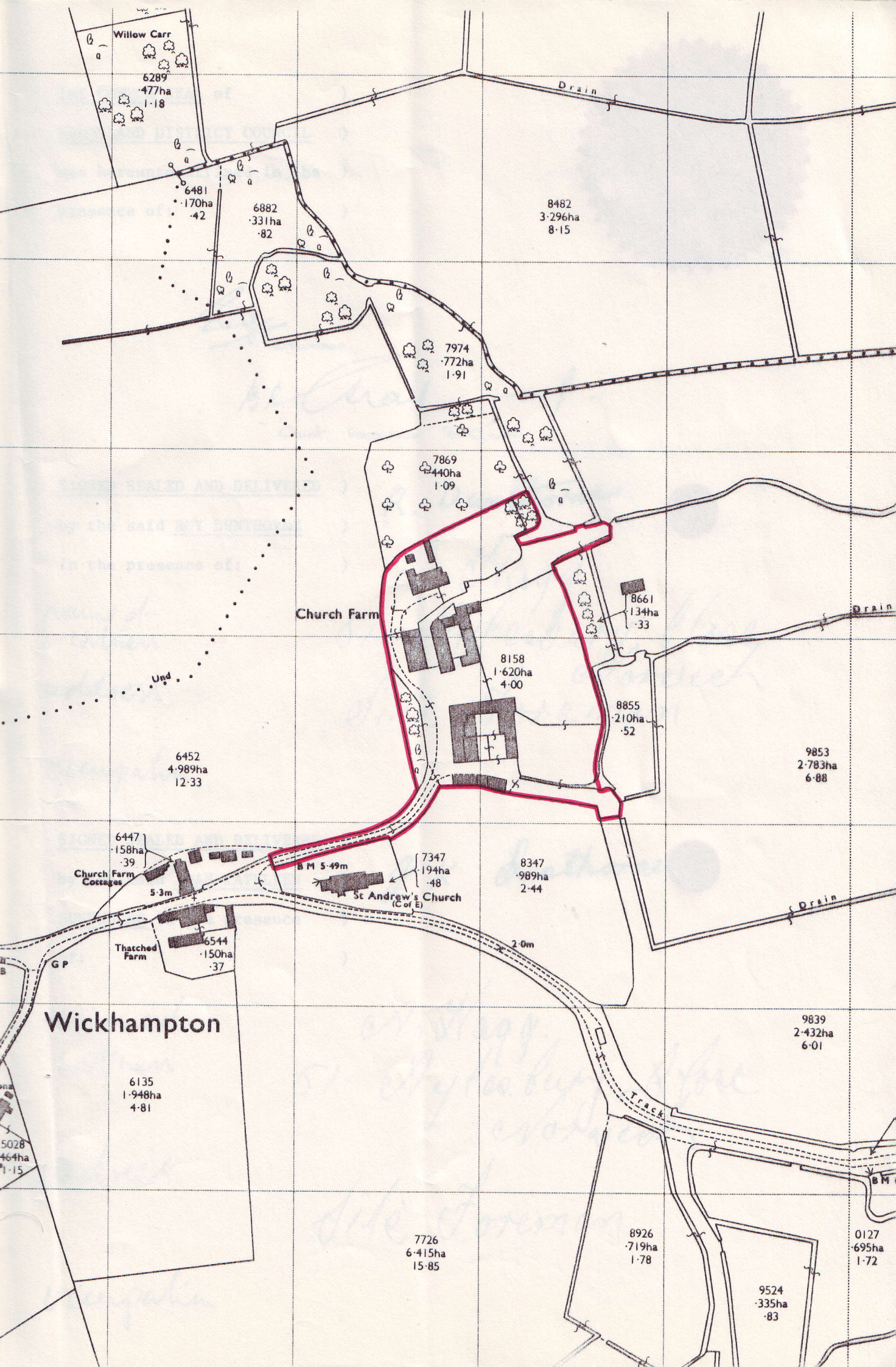

THE COMMON SEAL of)
BROADLAND DISTRICT COUNCIL)
was hereunto affixed in the)
presence of:)



E. W. Hagg
Chairman

J. K. Dunthorne
Chief Executive & Clerk

SIGNED SEALED AND DELIVERED)
by the said ROY DUNTHORNE)
in the presence of:)

R. Dunthorne

name of
witness
address

A. Hagg
51 Nylsbury Close
Crabwech
Site Foreman

occupation

SIGNED SEALED AND DELIVERED)
by the said JOAN KATHLEEN)
DUNTHORNE in the presence)
of:)

J. K. Dunthorne

named
witness
address

A. Hagg
51 Nylsbury Close
Crabwech
Site Foreman

occupation

SIGNED SEALED AND DELIVERED)

by the said PAUL STEPHEN)

DUNTHORNE in the presence)

of:)

name of
witness

address

occupation

Paul S Dunthorne

P Dunthorne

C. Hagg
51 Nylsbery Gore
Crosby

S. E. Foreman

SIGNED SEALED AND DELIVERED)

by the said SANDRA)

DUNTHORNE in the presence)

of:)

name of
witness

address

occupation

Sandra Dunthorne

S. Dunthorne

C. Hagg
51 Nylsbery Gore
Crosby

S. E. Foreman

Dated 5th September 1982.

BROADLAND DISTRICT COUNCIL

and

ROY DUNTHORNE
JOAN KATHLEEN DUNTHORNE
PAUL STEPHEN DUNTHORNE
and
SANDRA DUNTHORNE

AGREEMENT

relating to a cattle building
at O.S.8158, Church Farm,
Wickhampton, Freethorpe.

S.52. Town and Country
Planning Act 1971.

K.M.FRANCIS,
District Solicitor & Deputy Clerk,
Broadland District Council,
Thorpe Lodge,
Yarmouth Road,
Norwich, NR7 ODU.