

THIS AGREEMENT is made the 10th day of
September One thousand nine hundred and eighty-six

BETWEEN THE NORFOLK COUNTY COUNCIL of County Hall Martineau Lane Norwich ("the County Council") of the first part DAVID DENNY WRIGHT of The Old Vicarage Moulton St. Mary ("the Owner") of the second part and VIOLET MAY EDWARDS and RICHARD JOHN EDWARDS of The Street Moulton St. Mary ("the Developers") of the third part

WHEREAS:-

- (1) The Owner is the owner in fee simple in possession free from incumbrances of the land shown edged red on the attached plan ("the said land")
- (2) The County Council is the highway authority within the meaning of the Highways Act 1980 for the highway known as The Street Moulton St. Mary
- (3) The Developers have made application to the Broadland District Council (reference 85/2386/CU) dated the 16th December 1985 ("the application") in accordance with the Town and Country Planning Act 1971 and the Orders and Regulations for the time being in force thereunder for planning permission to use the said land as a parking area for caravan transporter lorries ("the development")
- (4) There are highway objections to the application which can only be overcome by the works specified in Schedule 1 hereto ("the works")
- (5) The County Council are satisfied that this agreement will be for the benefit of the public

NOW THIS DEED WITNESSETH as follows:-

1. This Agreement is made in pursuance of Section 52 of the Town and Country Planning Act 1971 Section 111 of the Local Government Act 1972 Section 278 of the Highways Act 1980 Section 33 of the Local Government (Miscellaneous Provisions) Act 1982 and all other enabling powers

2. The Developers and the Owner hereby jointly and severally covenant that the development shall not be carried out on the said land until the works have been completed to the satisfaction of and in accordance with the requirements and specifications of the County Council

3. The expressions "the County Council" "the Owner" and "the Developers" shall include their respective successors and assigns as appropriate within the terms of Section 52 of the Town and Country Planning Act 1971

SCHEDULE 1

- (i) The construction of an access at point C of the attached plan
- (ii) The provision of a post and rail fence and live hedge along the line CD
- (iii) The reduction in height of the hedge to 1 metre above road level along the line AB and the maintenance of the hedge at this height
- (iv) The access to be laid out in such a way that vehicles are prevented from turning right into or left out of the said land
- (v) The provision of a turning area within the said land to enable vehicles to leave in forward gear only

I N W I T N E S S whereof the County Council has affixed its Common Seal and the Owner and the Developers have set their hand and seal

THE COMMON SEAL of THE NORFOLK)
COUNTY COUNCIL was hereunto)
affixed in the presence of:-)

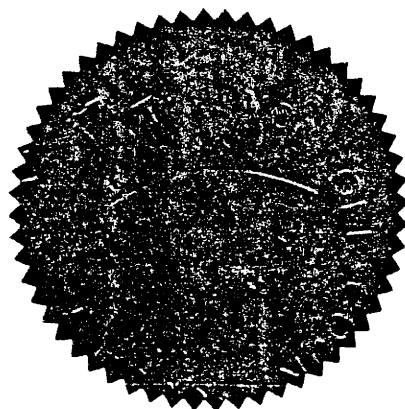

W. J. P. Clender

County Solicitor

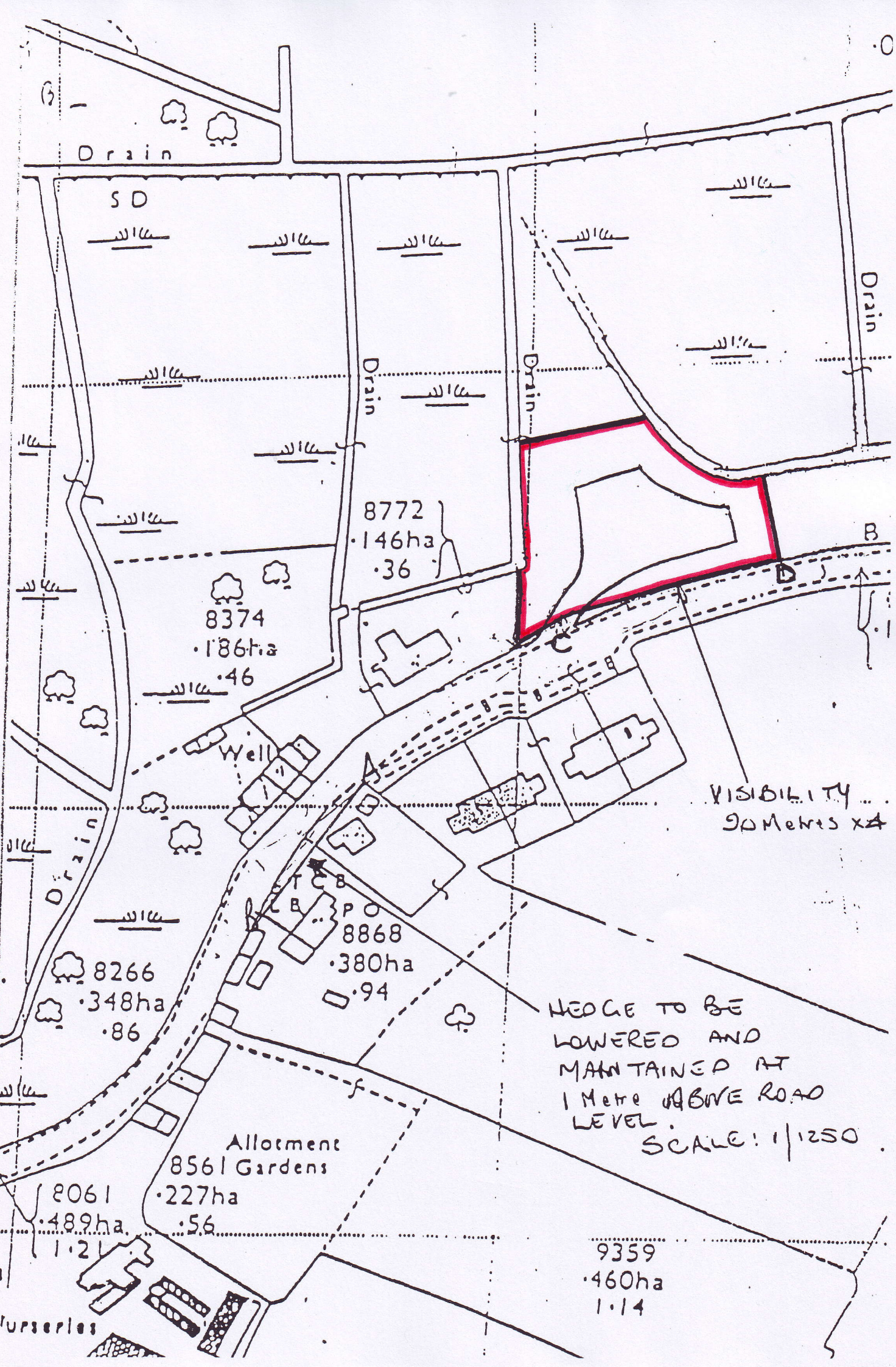

SIGNED SEALED AND DELIVERED by)
the said DAVID DENNY WRIGHT in)
the presence of:-)

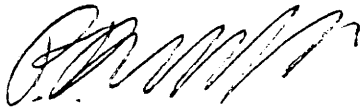

Old Vicarage,
Moulton St. Mary,
Norwich.

28.07.2011

SIGNED SEALED AND DELIVERED by)
the said VIOLET MAY EDWARDS in)
the presence of:-)

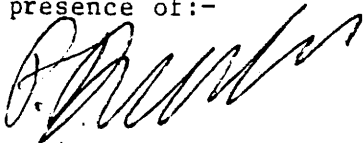

Old Vicarage,
Moulton St. Mary,
Norwich.

V. M. Edwards 

SIGNED SEALED AND DELIVERED by)
the said RICHARD JOHN EDWARDS)
in the presence of:-)

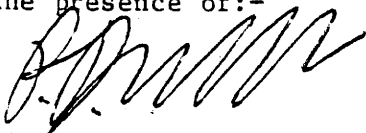

Old Vicarage,
Moulton St. Mary,
Norwich.

R. J. Edwards 

DATED 10th. September 1986

NORFOLK COUNTY COUNCIL

- and -

DAVID DENNY WRIGHT

- and -

VIOLET MAY EDWARDS

- and -

RICHARD JOHN EDWARDS

A G R E E M E N T

under Section 52 of the Town and Country
Planning Act 1971 relating to land at
Moulton St. Mary

T.D.W. Molander, Esq.,
County Solicitor,
Norfolk County Council,
County Hall,
Martineau Lane,
Norwich,

NR1 2DH