

T H I S A G R E E M E N T is made the 18TH day of MAY

One thousand nine hundred and eighty-seven

B E T W E E N THE NORFOLK COUNTY COUNCIL (hereinafter called "the County Council") of County Hall Martineau Lane Norwich of the first part ANNETTE GRACE WORTON (hereinafter called "the Owner") of c/o 20 Church Street Edmonton N9 of the second part

W H E R E A S:-

- (1) the County Council is the County Planning Authority within the meaning of the Town and Country Planning Act 1971 (as amended) and the Highway Authority within the meaning of the Highways Act 1980 (as amended)
- (2) the Owner is the estate owner in fee simple free from incumbrances of the land shown edged red on the annexed plan (hereinafter called "the said land")
- (3) The Owner is the administratrix of the estate of Alice Annie Elizabeth Bell deceased later of The Cottage Court Hill Frettenham Norfolk
- (4) application has been made to the Broadland District Council (reference 5/85/2019) dated the 14th October 1985 in accordance with the Town and Country Planning Act 1971 and the Orders and Regulations for the time being in force thereunder for planning permission for residential development of the said land (hereinafter called "the development")
- (5) there is at present no suitable outfall for surface water drainage from the roads and footpaths to be provided on the said land
- (6) to overcome the County Council's objection to the grant of planning permission for the development it is necessary that provision is made for a suitable highway surface water drainage system
- (7) the County Council are satisfied that this agreement will be for the benefit of the public

N O W T H I S D E E D W I T N E S S E T H as follows:-

1. This agreement is made in pursuance of Section 52 of the Town and Country Planning Act 1971 Section 111 of the Local Government Act 1972 Section 278 of the Highways Act 1980 Section 33 of the Local Government (Miscellaneous Provisions) Act 1982 and all other enabling powers
2. In the event that planning permission is granted for the development the Owner hereby covenants with the County Council that she will before any work on the said land commence contribute the sum of TEN THOUSAND POUNDS towards the future costs to be incurred by the County Council of providing an off site surface water drainage system to serve the said land
3. In the event of a surface water drainage outfall not being available when the development commences it is hereby agreed that the on site surface water drainage system will incorporate linked soakaways the connecting lengths of pipe being laid to the site boundary on a line and at levels previously approved by the County Council so that an eventual connection to the new surface water outfall can be achieved and where appropriate the soakaway chambers converted to manhole inspection chambers
4. Any disputes or differences between the parties hereto as to their respective rights duties or obligations under this agreement or the construction thereof as to any other matter or thing in any way arising out of or connected with this agreement shall be referred to the determination of an independent person to be agreed upon by the parties hereto and in default of agreement to be appointed on the application of either party hereto by the President for the time being of the Institution of Civil Engineers to determine the dispute of difference and the decision of such independent person shall be final and binding upon both parties hereto

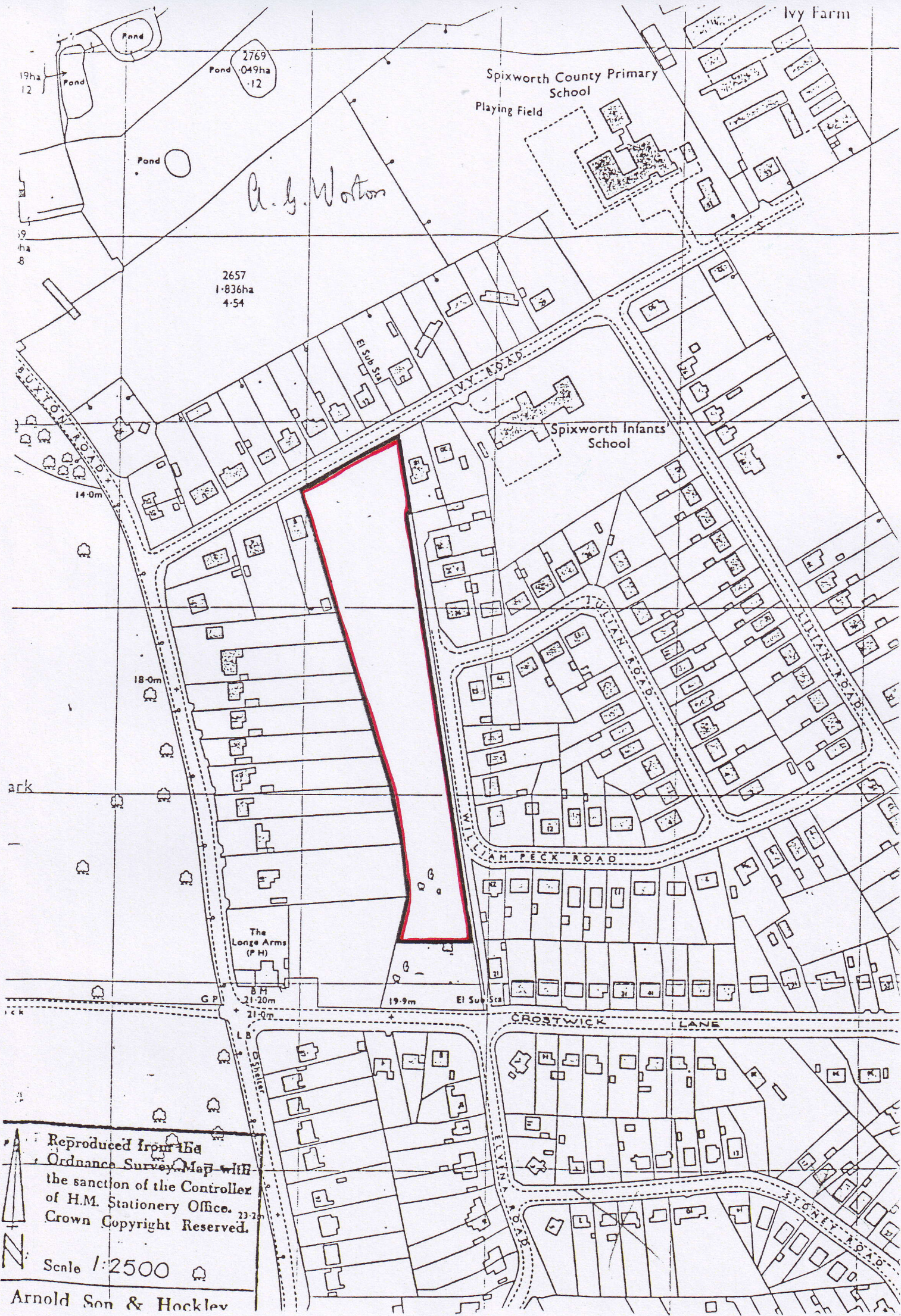

Reproduced from the
Ordnance Survey Map with
the sanction of the Controller
of H.M. Stationery Office.
Crown Copyright Reserved.

Scale 1:2500

Arnold Son & Hockley

5. The expressions "the County Council" and "the Owner" shall include their respective successors and assigns insofar as appropriate within the terms of Section 52 of the Town and Country Planning Act 1971 and Section 33 of the Local Government (Miscellaneous Provisions) Act 1982

I N W I T N E S S whereof the County Council has caused its Common Seal to be affixed and the Owner has set her hand and seal the day and year first before written

THE COMMON SEAL of THE NORFOLK)
COUNTY COUNCIL was hereunto)
affixed in the presence of:-)

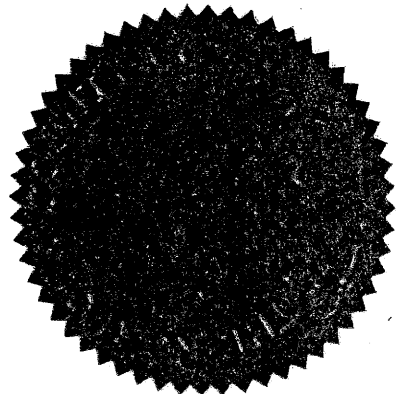

R M Auton

Authorised to sign on behalf
of the County Solicitor

SIGNED SEALED AND DELIVERED by)
the said ANNETTE GRACE WORTON)
in the presence of:-)

A. J. Worton



Witness

Name

Address

Occupation

Mr. C. G. Worton
56 Plough Hill
Gifford Heath
Norfolk

DATED 18TH MAY 1987

THE NORFOLK COUNTY COUNCIL

- and -

ANNETTE GRACE WORTON

A G R E E M E N T

under Section 52 of the Town and Country
Planning Act 1971 relating to land at
William Peck Road/Ivy Road, Spixworth

T.D.W. Molander, Esq.,
County Solicitor,
Norfolk County Council,
County Hall,
Martineau Lane,
Norwich.
NR1 2DH