

THIS AGREEMENT is made the 31st day of October 1988 BETWEEN BROADLAND DISTRICT COUNCIL of Thorpe Lodge Yarmouth Road Norwich in the County of Norfolk (hereinafter called "the Council") of the one part and DAVID GRAHAM COLLINS and MARGARET LOUISE COLLINS both of Apple Tree Bungalow Smee Lane Great Plumstead in the said County (hereinafter called "the Owners") of the other part

WHEREAS

1. The Council is a Local Planning Authority for the purposes of this Agreement
2. The owners are seised in fee simple absolute in possession of the property described in the First Schedule hereto (hereinafter called "the Property") free from incumbrances
3. The Owners have applied to the Council under reference number 88.1793 for planning permission for the erection of a dwelling (to be known as Tudor Lodge) on the Property which proposed dwelling is shown on the plan annexed hereto and thereon edged blue
4. The Council and the Owners have agreed subject to planning permission being granted in consequence of the aforesaid application to enter into this agreement pursuant to Section 52 of the Town and Country Planning Act 1971

NOW THIS DEED WITNESSETH as follows:-

1. Subject to planning permission being granted in consequence of application number 88.1793 and pursuant to the said Section 52 the Owners hereby jointly and severally agree declare and covenant with the Council that from the date on which the aforesaid planning permission shall be granted the Property shall be permanently subject to the conditions restricting or regulating the development or use of the Property specified in the Second Schedule hereto
2. The expressions "the Council" and "the Owners" shall where the context so admits include their respective successors in title and assigns

IN WITNESS whereof the Council has caused its Common Seal to be affixed hereunto and the Owners have set hereunto their respective hands and seals the day and year first before written

THE FIRST SCHEDULE

ALL THAT piece or parcel of freehold land more particularly described in a Deed of Gift made the 30th day of April One thousand nine hundred and eighty between Robert John Bainbridge of the one part and Henry John Feilden of the other part together with the dwellinghouse erected thereon known as Apple Tree Bungalow or Apple Tree Cottage

THE SECOND SCHEDULE

At all times after the dwelling to be known as Tudor Lodge and the erection of which is authorised by planning permission Reference No 88.1793 is in a condition fit for human habitation not to use the existing dwelling shown on the plan annexed hereto and thereon edged red for any purpose other than a garage for motor vehicles used by occupants of the said new dwellinghouse

THE COMMON SEAL of BROADLAND)
DISTRICT COUNCIL was hereunto)
affixed in the presence of:-)



3566

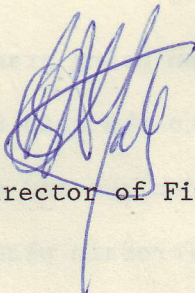

Deputy Director of Finance and Administration

SIGNED SEALED AND DELIVERED)

by the said DAVID GRAHAM)

COLLINS and MARGARET LOUISE)

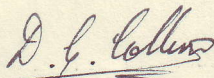
COLLINS in the presence of:-)



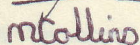

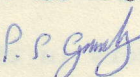

P. S. CREADY.

59 RAYMOND RD

NORWICH.

WORKS SUPERVISOR
BRITISH RAIL.

ADJOINING FARMLAND

NOTE
ALL TREES SHOWN
ARE PROPOSED NEW
SCHEME MAY VARY

PAIR OF EVERGREEN
FOREST TREES
TO GIVE PERMANENT
FRAME TO ELEVATION
OF HOUSE

PAIR OF DECIDUOUS
FOREST TREES
WILL NOT OBSTRUCT
LIGHT IN WINTER

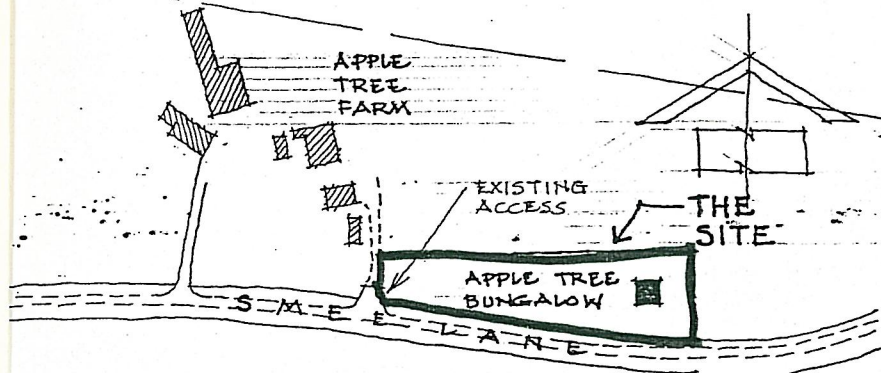
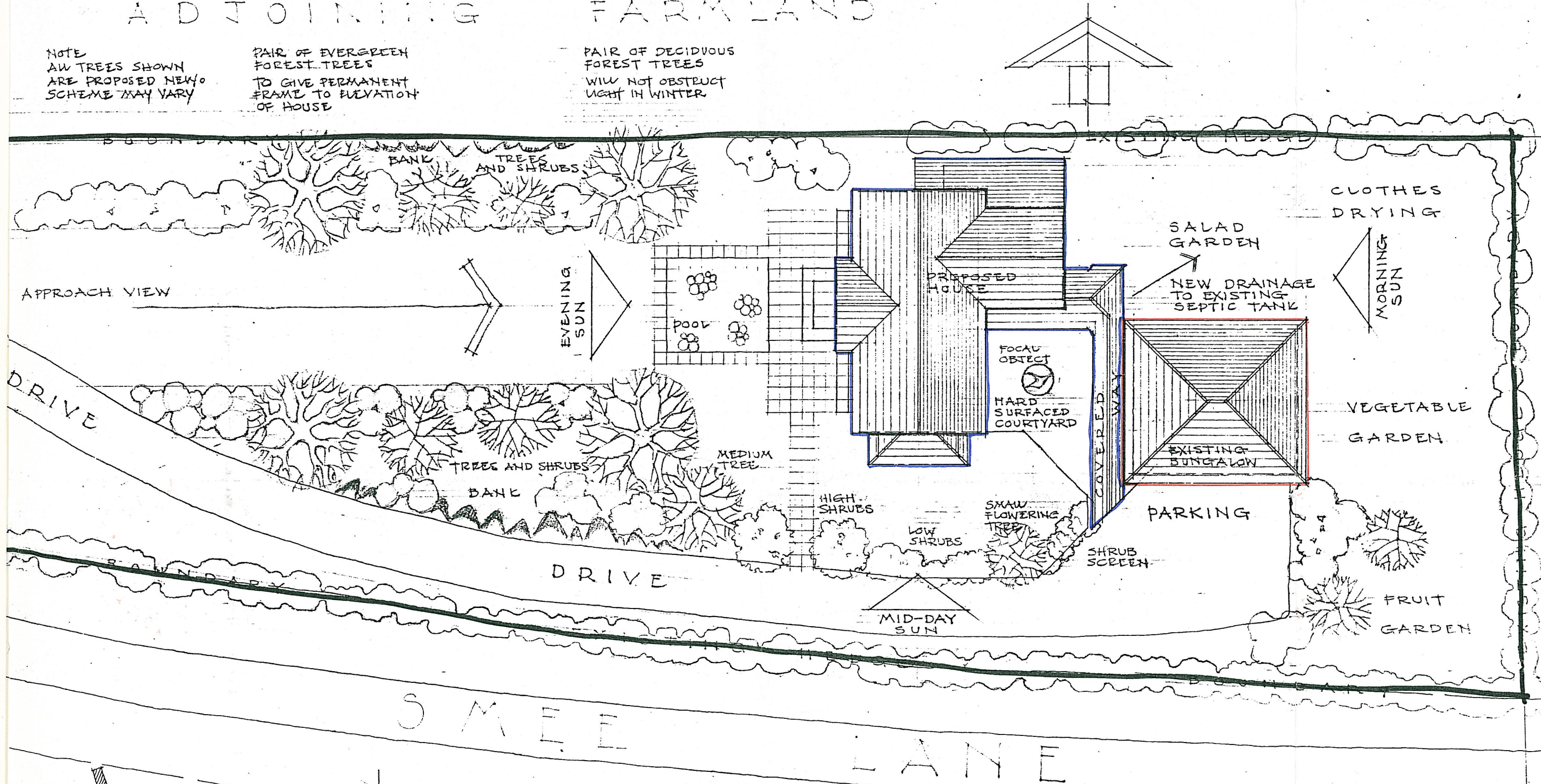

LOCATION PLAN
SCALE 1:2500 APPROX

SITE PLAN

PROPOSED HOUSE AND CONVERSION OF EXISTING BUNGALOW TO GARAGE FOR MR & MRS D.G. COLLINS

SCALE 1:200
DRAWING NUMBER 1

SEALING
DISTRICT COUNCIL
28 JUN 1985
SERVICES DIRECTOR

DATED 31st October 1988

BROADLAND DISTRICT COUNCIL

and

MR D G AND MRS M L COLLINS

S E C T I O N 52

A G R E E M E N T

B.A.Yates,
Head of Legal and Administrative
Services,
Broadland District Council,
Thorpe Lodge, Yarmouth Road,
Norwich, NR7 ODU.

LE108AGF0021:3