

9/52/4

THIS AGREEMENT is made the 1st day of July
One thousand nine hundred and eighty BETWEEN THE BROADLAND
DISTRICT COUNCIL (hereinafter called "the Council") of the one
part and KENNETH DYE of Fir Covert Poultry Farm, Fir Covert Road
Taverham in the County of Norfolk (hereinafter called "the Owner")
of the other part.

WHEREAS:

(1) The Council is the Local Planning Authority for the
purposes of this Agreement.

(2) The Owner is seised in unincumbered fee simple in
possession of the property described in the First Schedule (here-
inafter called "the Property").

NOW THIS DEED WITNESSETH as follows:-

1. Pursuant to Section 52 of the Town and Country Planning
Act 1971 and in consideration of the Council's covenant hereinafter
mentioned the Owner hereby agrees declares and covenants with the
Council that the Property shall be subject to the conditions
(restricting the development and/or use of the Property) specified
in the Second Schedule hereto.

2. In consideration of the Clause 1 hereof the Council hereby
agree with the Owner to issue a planning consent for the change of
use to use for retail sales of goods ancilliary to the produce of
the land and associated car parking on land described in the First
Schedule hereto (application number 80.0532).

3. The expressions "the Council" and "the Owner" shall where
the context admits include their respective successors in title
and assigns.

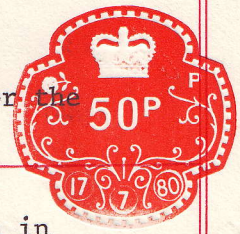

IN WITNESS whereof the Owner has hereunto set his Hand and
Seal and the Council have hereunto affixed their Common Seal. _____

Signed Sealed and Delivered)

by KENNETH DYE)

in the presence of:)

) V.A. Hill
) FIA COURT ROAD
) TAVERHAM.
)
) Roger H. Redfern.
) Rugby Cottage
) Berston
) Diss
) Norfolk

The Common Seal of the)

BROADLAND DISTRICT COUNCIL)

was hereunto affixed in the)
presence of:)

)
)
) Vice Chairman
)
)
)
) Chief Executive and Clerk.



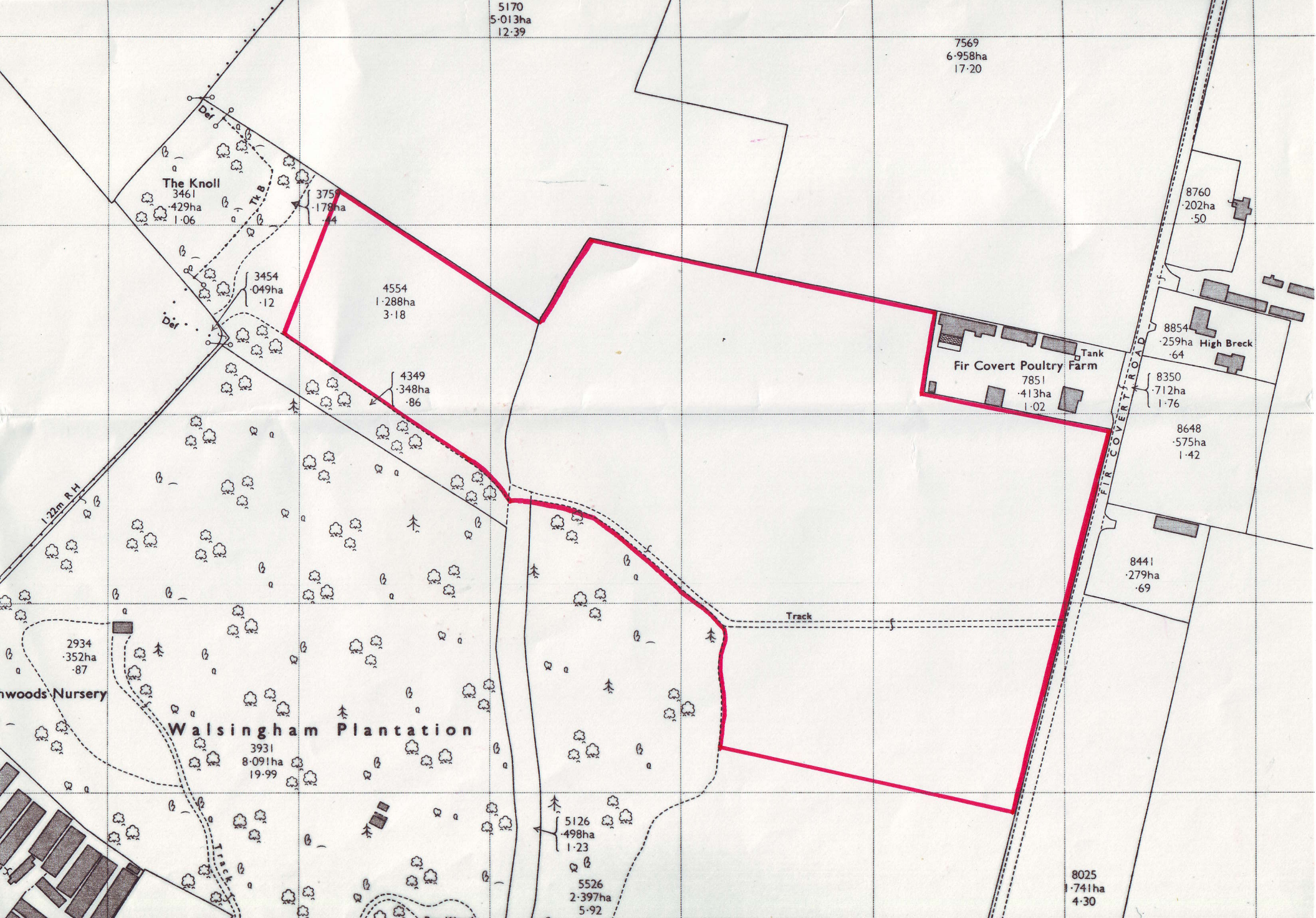

THE FIRST SCHEDULE REFERRED TO: THE PROPERTY

All that land at Taverham in the County of Norfolk adjacent to Fir Covert Road and known as Fir Covert Poultry Farm shown on the plan attached hereto and thereon edged red.

THE SECOND SCHEDULE REFERRED TO: THE RESTRICTIONS

Apart from the produce of the soil of the land described in the First Schedule hereto, only the following items may be sold from the said land:-

Peat

Potting and Seed Compost

Fertilizer

Pesticides

Seeds of various types

Stakes

Canes

Twine

Plant Labels

Plant containers, various sizes
seed trays

Bulbs

Seed Potatoes

Strawberry Runners

Raspberry Colts

Tree Bands

Dated 1st July 1980

BROADLAND DISTRICT COUNCIL

and

KENNETH DYE

SECTION 52 AGREEMENT

B.R. Grayling, DMA, MILGA,
Chief Executive and Clerk,
Broadland District Council,
Thorpe Lodge,
Yarmouth Road,
Norwich,
NR7 ODU.